

INTERLAKEN

Date: 9/20/2023 **Author:** Interlaken, Inc. **Project:** 129th Ave & King Road Utility Undergrounding

Comments:

- For work on SE 129th Ave Station 5+50 to 7+50
- Proposed speed reduction for safer work zones
- Closure of southbound lane on SE 129th Ave
- Southbound lane shift to center to maintain traffic flow
- Driveways will maintain access all hours
- Closure during work hours: 8 AM - 5 PM



INTERLAKEN

Date: 9/20/2023 **Author:** Interlaken, Inc. **Project:** 129th Ave & King Road Utility Undergrounding

Comments:

- For work on SE 129th Ave Station 7+50, trenching across road
- Proposed speed reduction for safer work zones
- Closure of one lane to allow for trenching in roadway
- Flaggers to control peds/bikes as necessary
- Driveways will maintain access all hours
- Closure during work hours: 8 AM - 5 PM

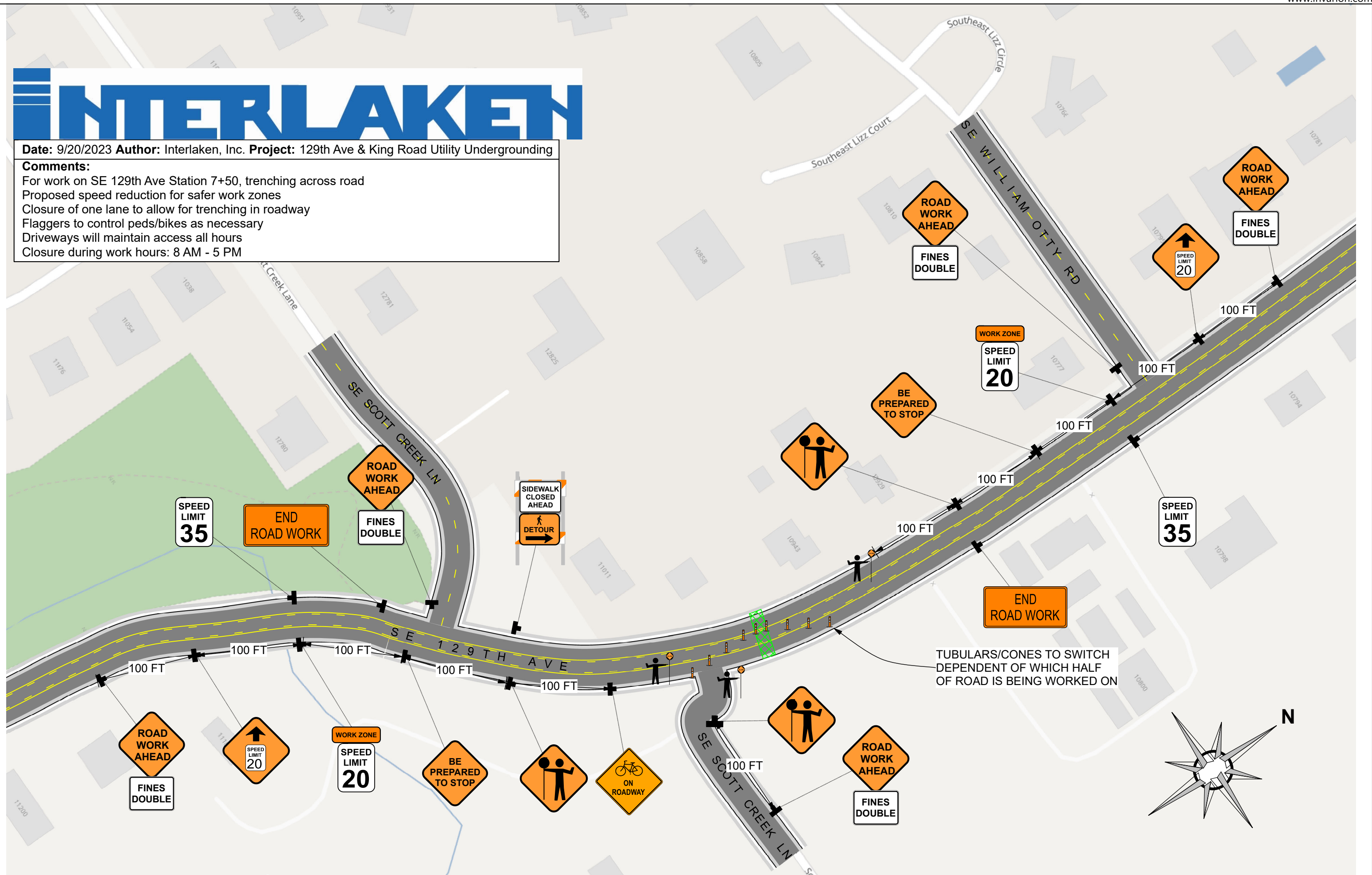

INTERLAKEN

Date: 9/20/2023 **Author:** Interlaken, Inc. **Project:** 129th Ave & King Road Utility Undergrounding

Comments:
For work on SE 129th Ave Station 7+50 to 10+50
Proposed speed reduction for safer work zones
Closure of southbound lane on SE 129th Ave
Southbound lane shift to center to maintain traffic flow
Driveways will maintain access all hours
Closure during work hours: 8 AM - 5 PM



INTERLAKEN

Date: 9/20/2023 Author: Interlaken, Inc. Project: 129th Ave & King Road Utility Undergrounding

Comments:

- For work on SE 129th Ave Station 10+50, trenching across road
- Proposed speed reduction for safer work zones
- Closure of one lane to allow for trenching in roadway
- Flaggers to control peds/bikes as necessary
- Driveways will maintain access all hours
- Closure during work hours: 8 AM - 5 PM



INTERLAKEN

Date: 9/20/2023 **Author:** Interlaken, Inc. **Project:** 129th Ave & King Road Utility Undergrounding

Comments:

- For work on SE 129th Ave Station 10+50 to 13+25
- Proposed speed reduction for safer work zones
- Closure of southbound lane on SE 129th Ave
- Southbound lane shift to center to maintain traffic flow
- Driveways will maintain access all hours
- Closure during work hours: 8 AM - 5 PM



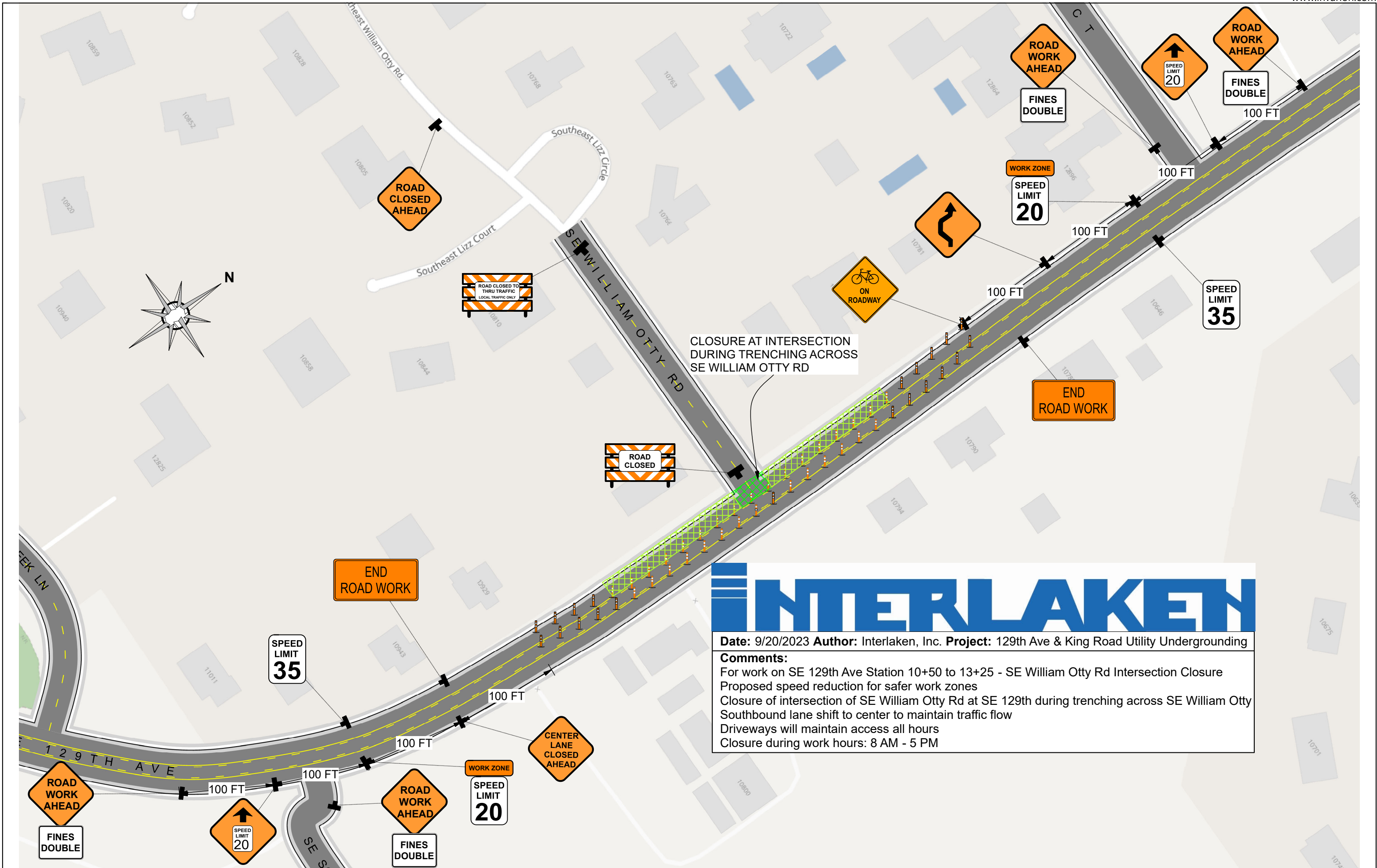

INTERLAKEN

Date: 9/20/2023 **Author:** Interlaken, Inc. **Project:** 129th Ave & King Road Utility Undergrounding

Comments:
 For work on SE 129th Ave Station 10+50 to 13+25 - SE William Otty Rd Intersection Closure
 Proposed speed reduction for safer work zones
 Closure of intersection of SE William Otty Rd at SE 129th during trenching across SE William Otty
 Southbound lane shift to center to maintain traffic flow
 Driveways will maintain access all hours
 Closure during work hours: 8 AM - 5 PM

INTERLAKEN

Date: 9/20/2023 **Author:** Interlaken, Inc. **Project:** 129th Ave & King Road Utility Undergrounding

Comments:
 For work on SE 129th Ave Station 13+25 TO 18+75
 Proposed speed reduction for safer work zones
 Closure of southbound lane on SE 129th Ave
 Southbound lane shift to center to maintain traffic flow
 Driveways will maintain access all hours
 Closure during work hours: 8 AM - 5 PM



INTERLAKEN

Date: 9/20/2023 **Author:** Interlaken, Inc. **Project:** 129th Ave & King Road Utility Undergrounding

Comments:
 For work on SE 129th Ave Station 13+25 to 14+75, trenching across road
 Proposed speed reduction for safer work zones
 Closure of one lane to allow for trenching in roadway
 Flaggers to control peds/bikes as necessary
 Driveways will maintain access all hours
 Closure during work hours: 8 AM - 5 PM

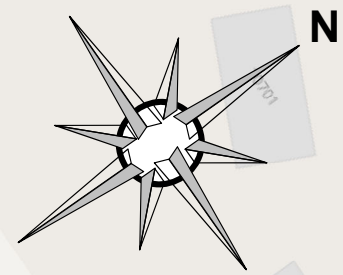
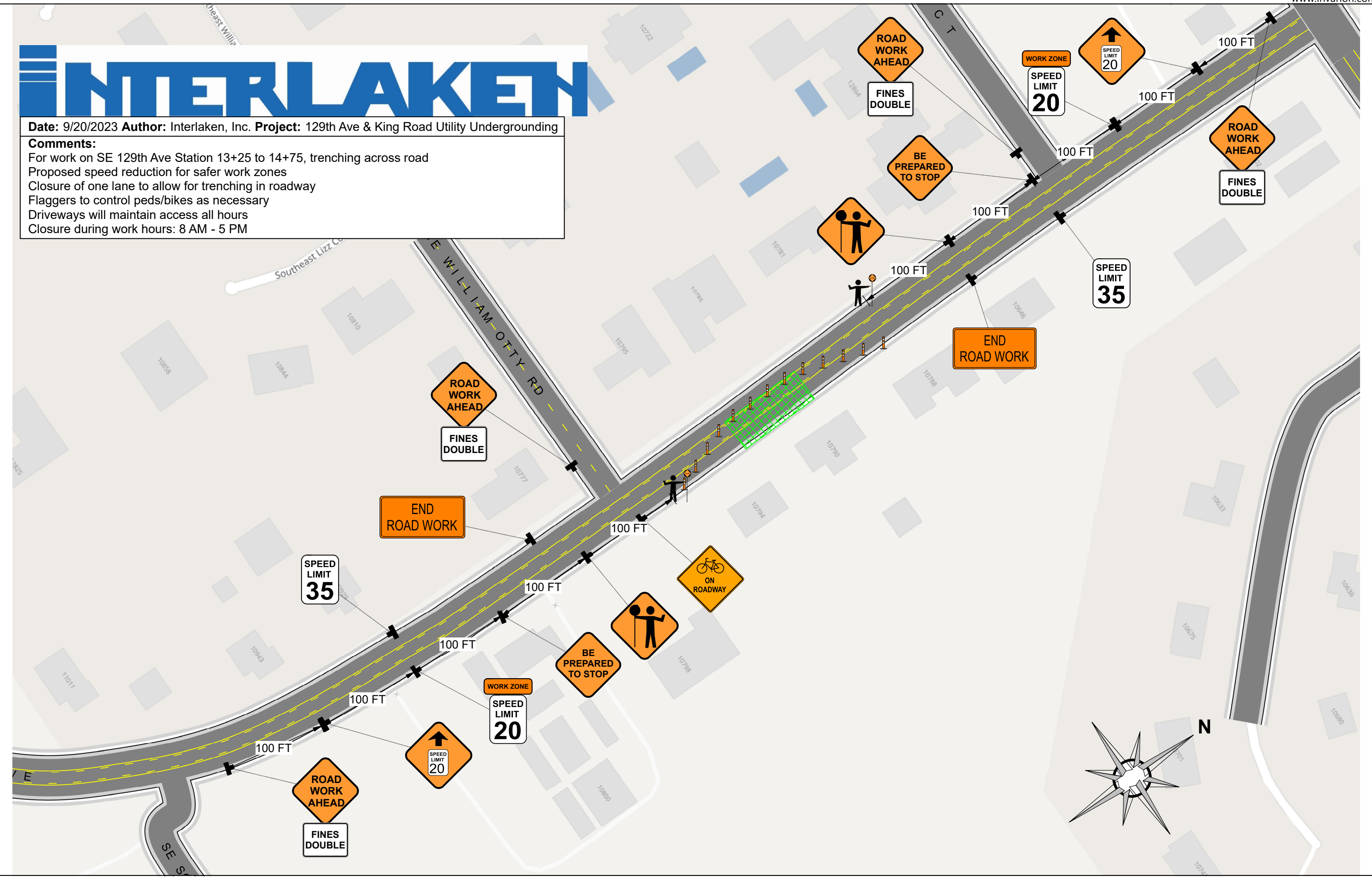

INTERLAKEN

Date: 9/20/2023 **Author:** Interlaken, Inc. **Project:** 129th Ave & King Road Utility Undergrounding

Comments:
 For work on SE 129th Ave Station 18+75, trenching across road
 Proposed speed reduction for safer work zones
 Closure of one lane to allow for trenching in roadway
 Flaggers to control peds/bikes as necessary
 Driveways will maintain access all hours
 Closure during work hours: 8 AM - 5 PM



INTERLAKEN

Date: 9/20/2023 **Author:** Interlaken, Inc. **Project:** 129th Ave & King Road Utility Undergrounding

Comments:

- For work on SE 129th Ave Station 18+75 TO 19+50
- Proposed speed reduction for safer work zone
- Closure of southbound lane on SE 129th Ave
- Southbound lane shift to center to maintain traffic flow
- Driveways will maintain access all hours
- Closure during work hours: 8 AM - 5 PM

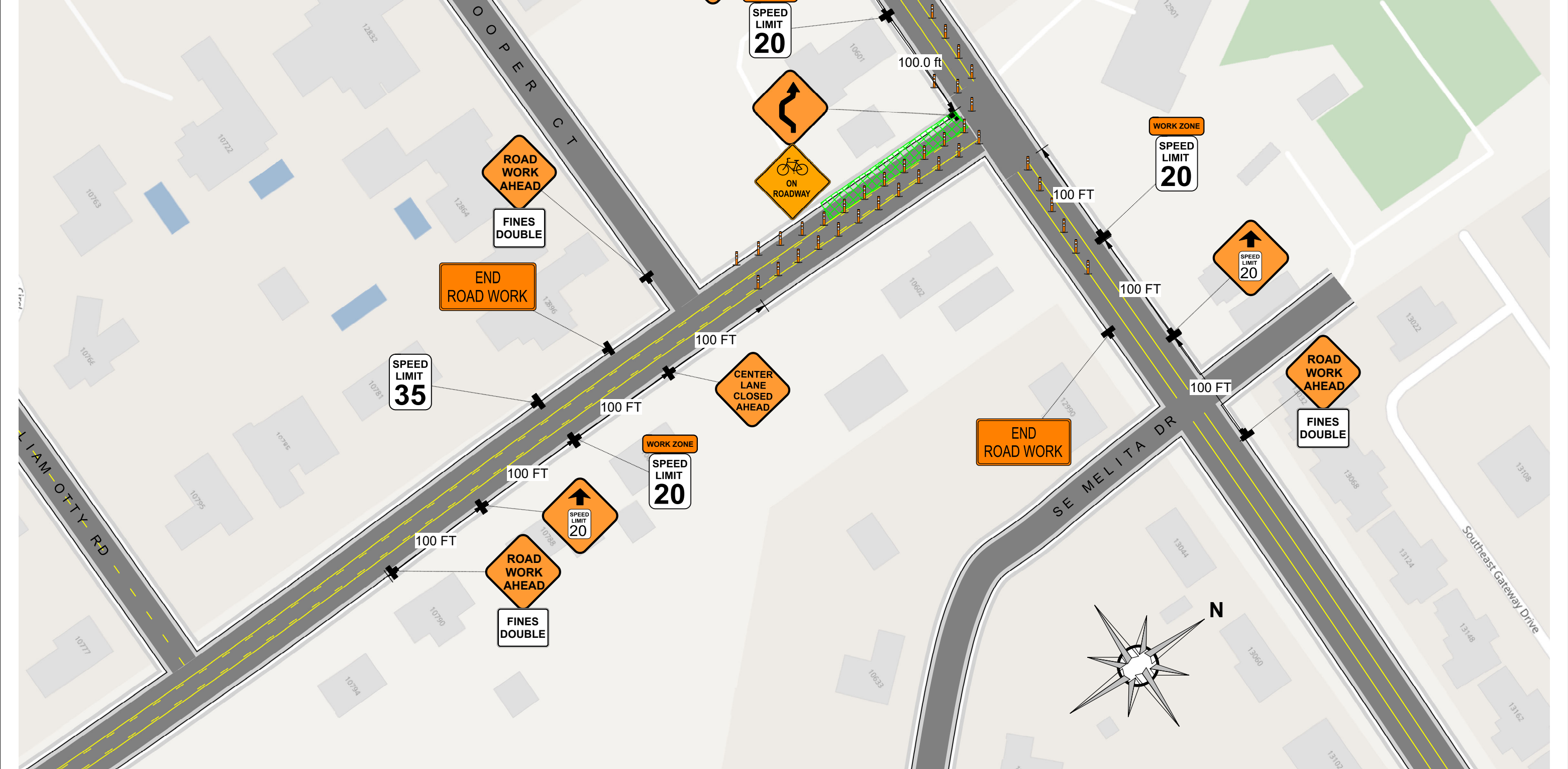

INTERLAKEN

Date: 9/20/2023 Author: Interlaken, Inc. Project: 129th Ave & King Road Utility Undergrounding

Comments:
 For work on SE King Rd Station 5+00 to 7+50
 Proposed speed reduction for safer work zones
 Closure of northbound lane on SE Kind Rd
 Northbound lane shift to center to maintain traffic flow
 Driveways will maintain access all hours
 Closure during work hours: 8 AM - 5 PM

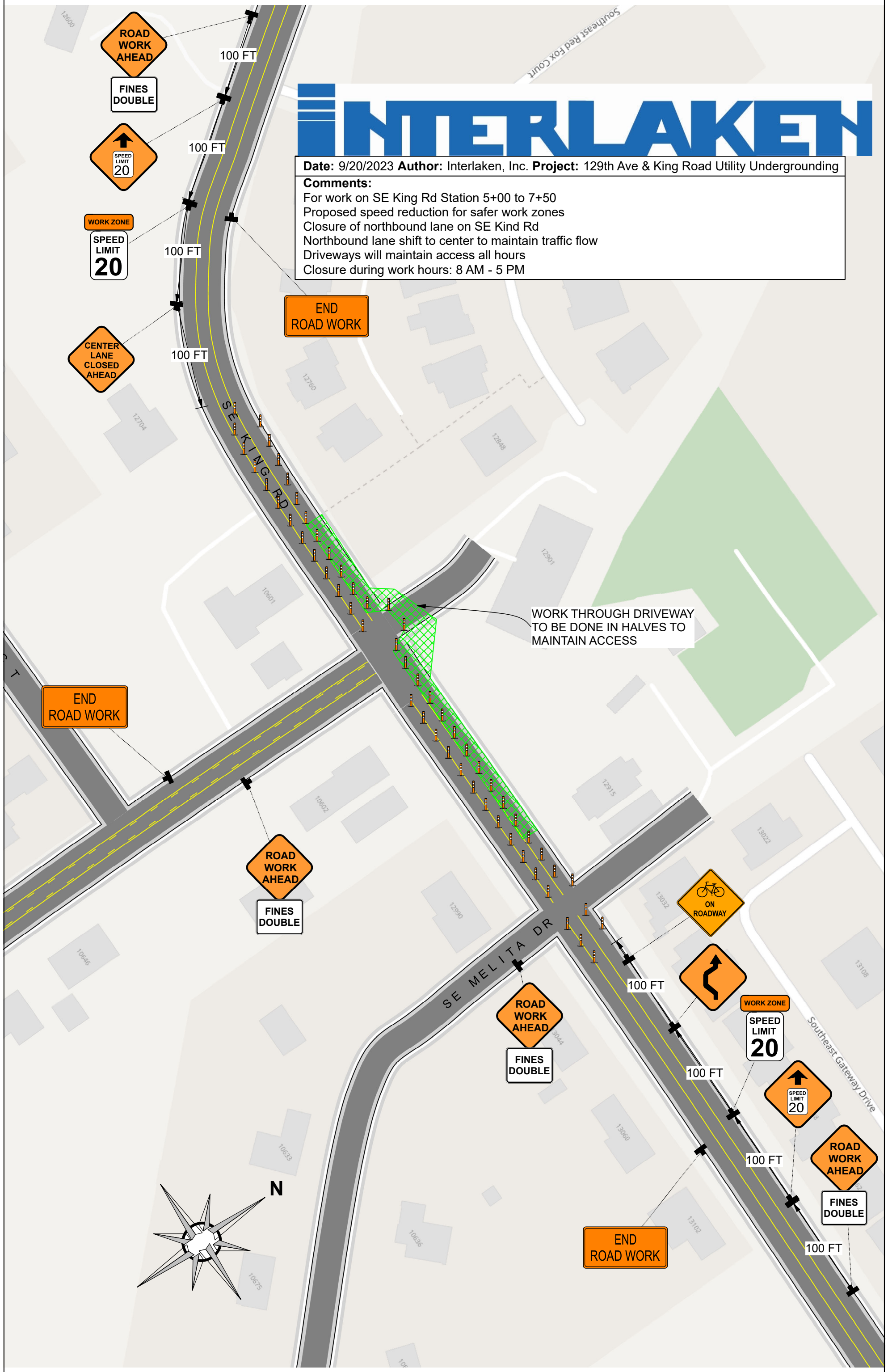

INTERLAKEN

Date: 9/20/2023 Author: Interlaken, Inc. Project: 129th Ave & King Road Utility Undergrounding

Comments:
For work on SE King Road Station 7+00 to 8+50, trenching across road
Proposed speed reduction for safer work zones
Closure of one lane to allow for trenching in roadway
Flaggers to control peds/bikes as necessary
Driveways will maintain access all hours
Closure during work hours: 8 AM - 5 PM

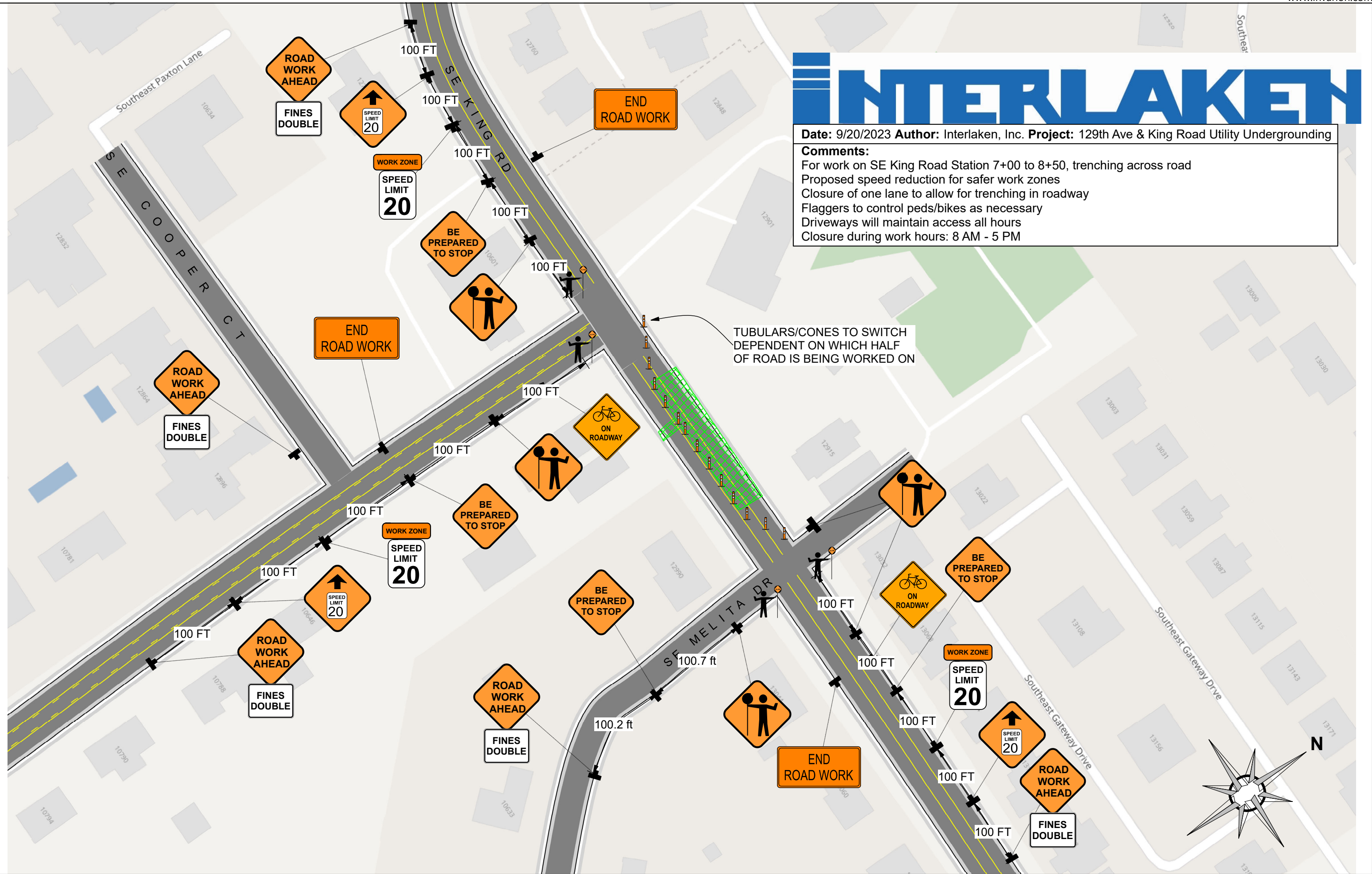

INTERLAKEN

Date: 9/20/2023 **Author:** Interlaken, Inc. **Project:** 129th Ave & King Road Utility Undergrounding

Comments:
For work on SE King Road Station 8+50 to 9+50, trenching across road
Proposed speed reduction for safer work zones
Closure of one lane to allow for trenching in roadway
Flaggers to control peds/bikes as necessary
Driveways will maintain access all hours
Closure during work hours: 8 AM - 5 PM

